

Features

- 1/2.8" SONY Progressive scan CMOS
- Low illumination, Hisilicon DSP
- H.264/MJPEG dual-stream encoding
- Day/Night (ICR), support Onvif 2.2
- 12-2.8mm HD Zoom lens
- IP66 water proof rating, vandal proof
- With PoE



SPECIFICATION

Model	PR IP-8613 VIB	PR IP-8620 VIB
Image Sensor	1/3" SONY Low Illumination Progressive Scan CMOS	1/2.8" SONY Low Illumination Progressive Scan CMOS
Effective Pixels	1280(H)*1024(V) 1.3 megapixel	1920(H)*1080(V) 2 megapixel
Lens	M12 interface, 3.6 mm High definition lens	
Shutter time	1/25s to 1/8000 s	
Signal System	PAL(25FPS)/NTSC(30FPS)	
S/N Ratio	≥50dB (AGC OFF)	
D-WDR	≥100db	
D&N	Support the IR- CUT switch ,ICR infrared filter	
LED	Φ5 x 24pcs LED	
Sensitivity	Color 0.05Lux@(F1.2,AGC ON), B/W 0.01Lux@(F1.2,AGC ON)	
Video Compression	H.264 Baseline, Main Profile, MJPEG	
Bit Rate	32Kbps~16Mbps CBR/VBRs	
Frame rate	1 to 30 FPS adjustable	
Resolution	Main stream: 1920*1080, 1280*720 Sub stream: 720*576, 640*480, 640*352, 320*240	
OSD Control	Supports channel name, date, and video stream information Superimposition supported, Location adjustable	
Image Settings	Saturation, brightness, contrast adjustable by client , web browser	
Network Protocols	TCP/IP, UDP, SMTP, HTTP, FTP, PPPOE, DHCP, DNS, DDNS, NTP, UPNP, RTP, RTSP	
Web browse	Internal Web Serve, Support IE6.0 or up Access service, 16 users max	
Data storage	Video, Picture	
storage mechanism	Manual, automatic (cycle, time, alarm, switch, and motion detecting)	
Recording	Motion detection, video occlusion, video loss and set alarm time	
Alarm transmission	FTP, E-mail, browse, management software	
Access Protocol	ONVIF2.2 standard, Compatible with mainframe NVR	
Network Port	1 RJ45 10/100M self-adaptive Ethernet port	
Video port	1 channel BNC Video Output	
Operating Conditions	-20°C~+55°C; Humidity 90% or less (non-condensing)	
Power Supply	DC12V/1A	
Power Consumption	4.5W (MAX)	
IR distance	25M	
Weight	220g	
Dimensions	Φ113x85mm	

DIMENSION

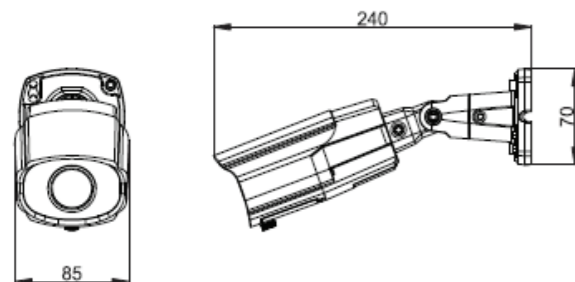

PoE(Power Over Ethernet)

The series is enable IEEE 802.3af, Class 3 standard of power-over-ethernet applications to allow the supply of power over the LAN cables, thereby simplifies the installation procedures. Cat5 Cable or higher (Cat5e, Cat6) cables are suitable. However the optional/ additional 12V DC socket is available. The network allows simultaneous recording on local built-in micro SD card or over remote FTP server. The TCP/IP IPv4 and IPv6 (DHCP fixed) versions are incorporated.



PROLINE UK ELECTRONICS LTD. is the member of Onvif (Open Network Video Interface Forum)

Features

- High-performance Hisilicon DSP and CMOS image sensor
- H.264/MJPEG dual-stream encoding
- Low illumination, Hisilicon DSP
- Day/Night (ICR), support Onvif 2.2
- Support connection with HVR/NVR, Compatible with ONVIF standard
- 2pcs high quality Array infrared, IR distance 50 meters
- With POE



SPECIFICATION

MODEL	PR IP-8313 IVB	PR IP-8320 IVB
Image Sensor	1/3" SONY Low Illumination Progressive Scan CMOS	1/2.8" SONY Low Illumination Progressive Scan CMOS
Effective Pixels	1280(H)*1024(V) 1.3 megapixel	1920(H)*1080(V) 2 megapixel
Lens	M14 interface 2.8 to 12 mm High definition lens	
Shutter time	1/25s to 1/8000 s	
Signal System	PAL(25FPS)/NTSC(30FPS)	
S/N Ratio	≥50dB (AGC OFF)	
D-WDR	≥100db	
D&N	Support the IR- CUT switch ,ICR infrared filter	
LED	2pcs Array	
Sensitivity	Color 0.05Lux@(F1.2,AGC ON), B/W 0.01Lux@(F1.2,AGC ON)	
Video Compression	H.264 Baseline, Main Profile, MJPEG	
Bit Rate	32Kbps~16Mbps adjustable	
Frame rate	1 to 30 FPS adjustable	
Resolution	Main stream: 1920*1080, 1280*720 Sub stream: 720*576, 640*480, 640*352, 320*240	
OSD Control	Supports channel name, date, and video stream information Superimposition supported, Location adjustable	
Image Settings	Saturation, brightness, contrast adjustable by client , web browser	
Network Protocols	TCP/IP, UDP, SMTP, HTTP, FTP, PPPOE, DHCP, DNS, DDNS, NTP, UPNP, RTP, RTSP	
Web browse	Internal Web Serve, Support IE6.0 or up Access service, 16 users max	
Data storage	Video, Picture	
storage mechanism	Manual, automatic (cycle, time, alarm, switch, and motion detecting)	
Recording	Motion detection, video occlusion, video loss and set alarm time	
Alarm transmission	FTP, E-mail, browse, management software	
Access Protocol	ONVIF2.2 standard, Compatible with mainframe NVR	
Network Port	1 RJ45 10/100M self-adaptive Ethernet port	
Video port	1 channel BNC Video Output	
Operating Conditions	-20°C~+55°C; Humidity 90% or less (non-condensing)	
Power Supply	DC12V/1A(PoE Optional)	
Power Consumption	6W (MAX)	
IR distance	50-60 Meters	
Dimensions	270x107x148mm	
Weight	600g	

DIMENSION

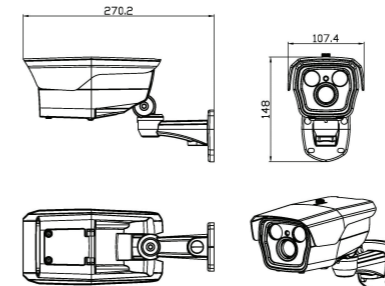

PoE(Power Over Ethernet)

The series is enable IEEE 802.3af, Class 3 standard of power-over-ethernet applications to allow the supply of power over the LAN cables, thereby simplifies the installation procedures. Cat5 Cable or higher (Cat5e, Cat6) cables are suitable. However the optional/ additional 12V DC socket is available. The network allows simultaneous recording on local built-in micro SD card or over remote FTP server. The TCP/IP IPv4 and IPv6 (DHCP fixed) versions are incorporated.



PROLINE UK ELECTRONICS LTD. is the member of Onvif (Open Network Video Interface Forum)